

Utbytesanvisning

SRAB 99D och SRAB Föravskiljare

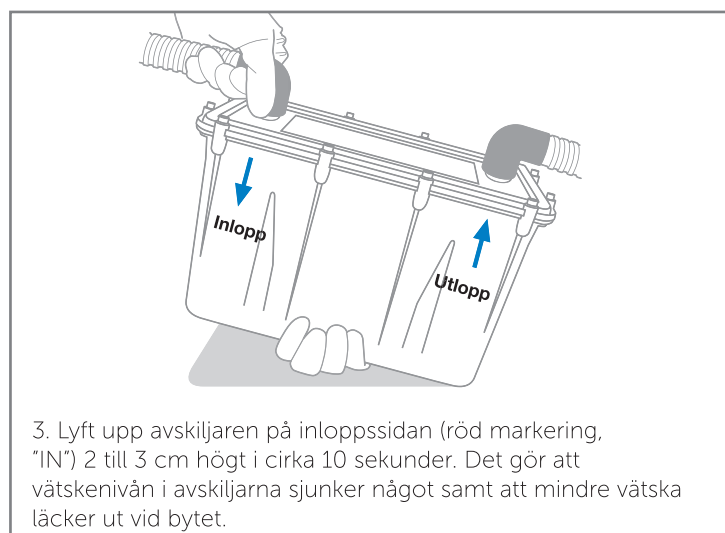

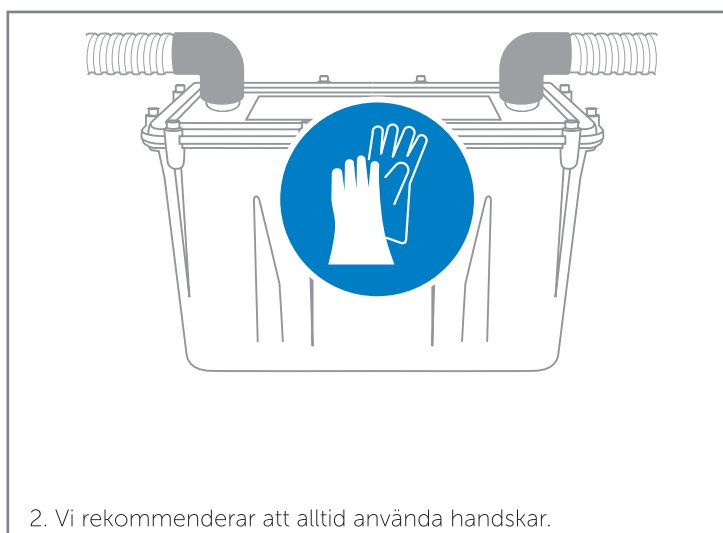
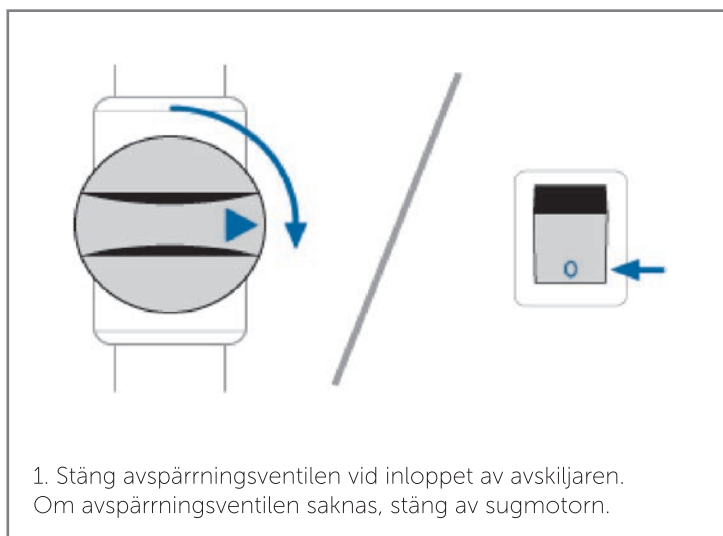
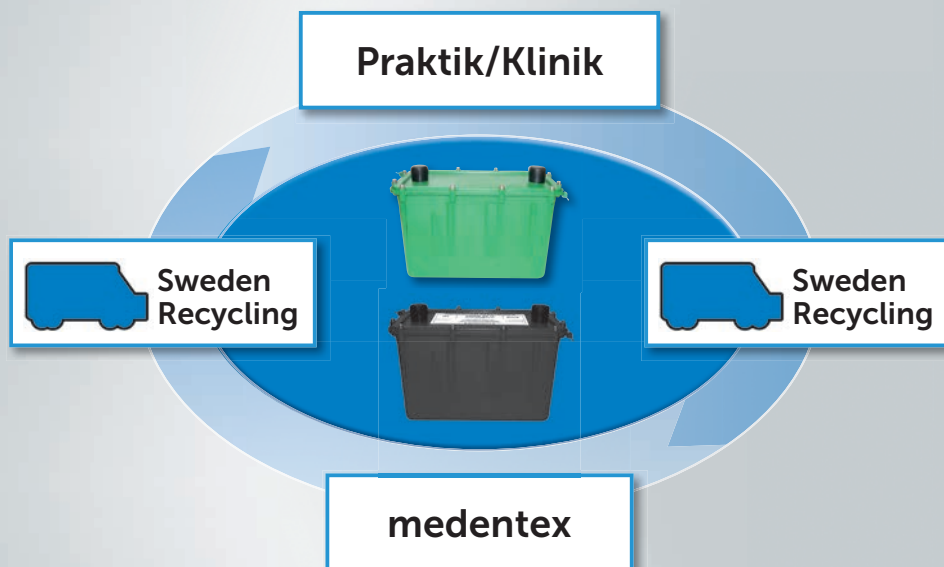
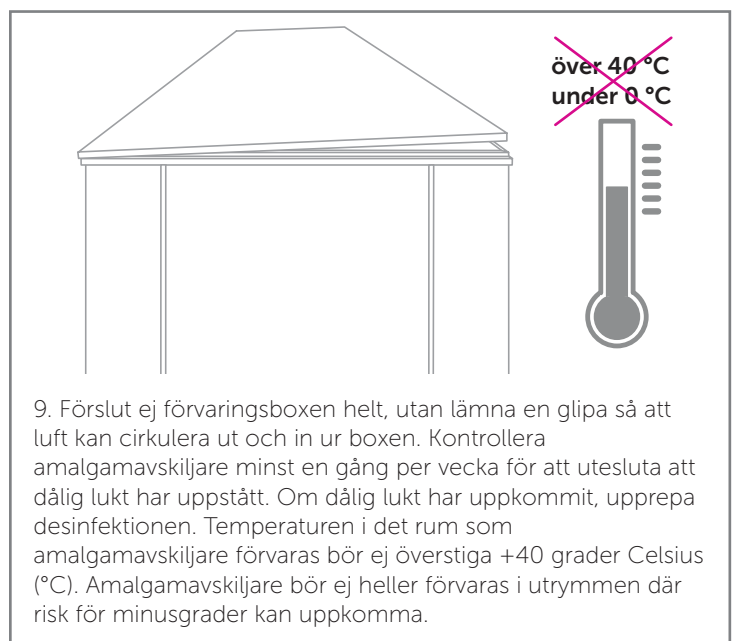
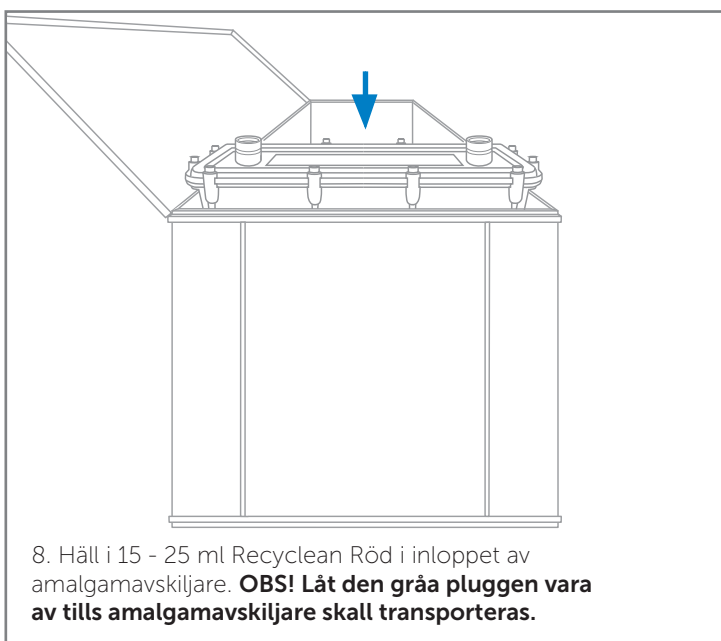
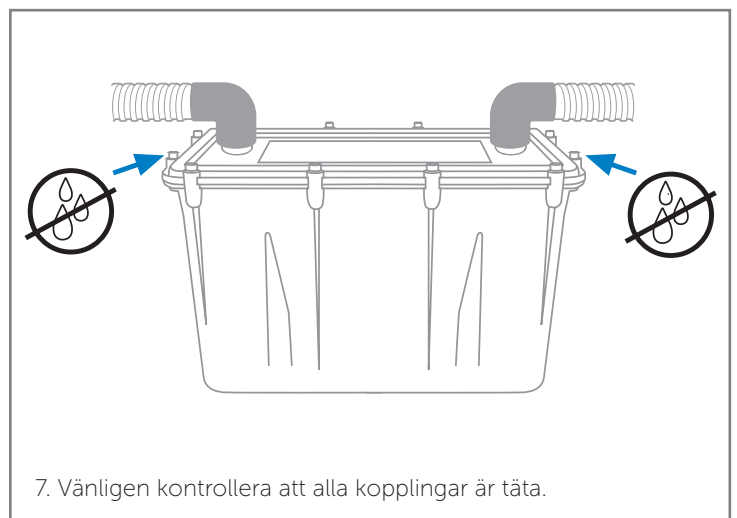
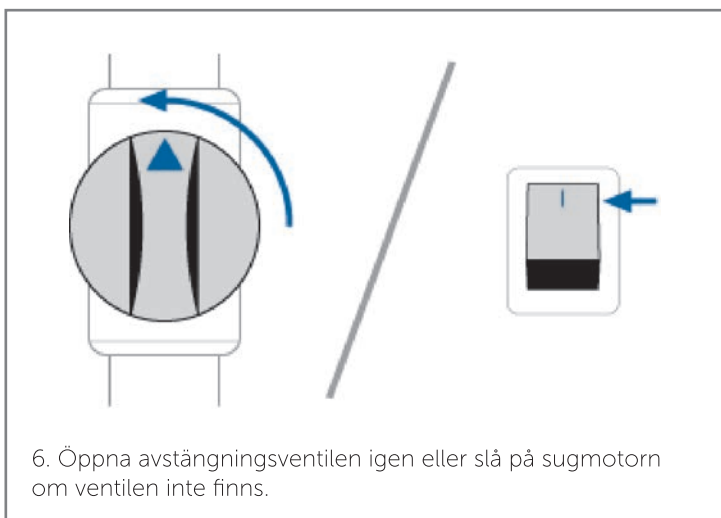
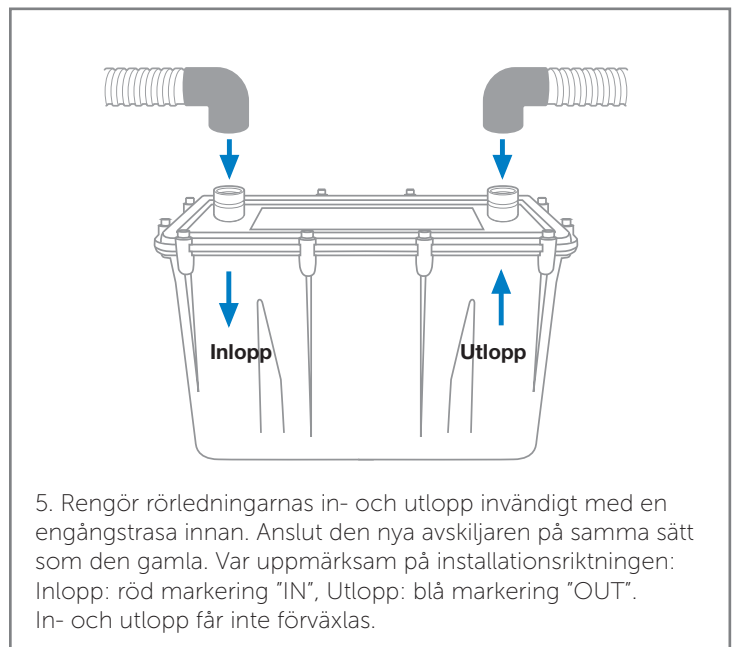
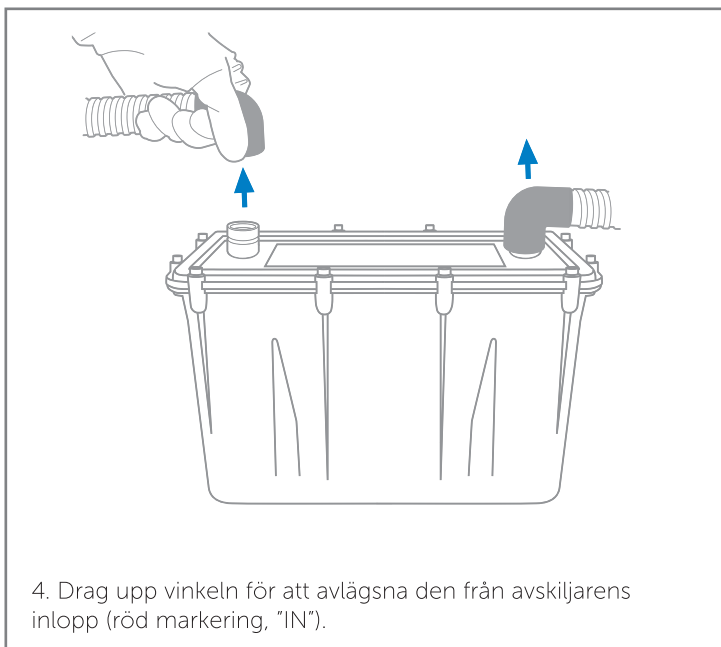

Innan transport: Kontrollera att läckage ej har uppkommit från amalgamavskiljare. Förslut amalgamavskiljare / inlopp med den gråa pluggen. Säkerställ att lock till förvaringsboxen är tillslutet på ett korrekt sätt.